

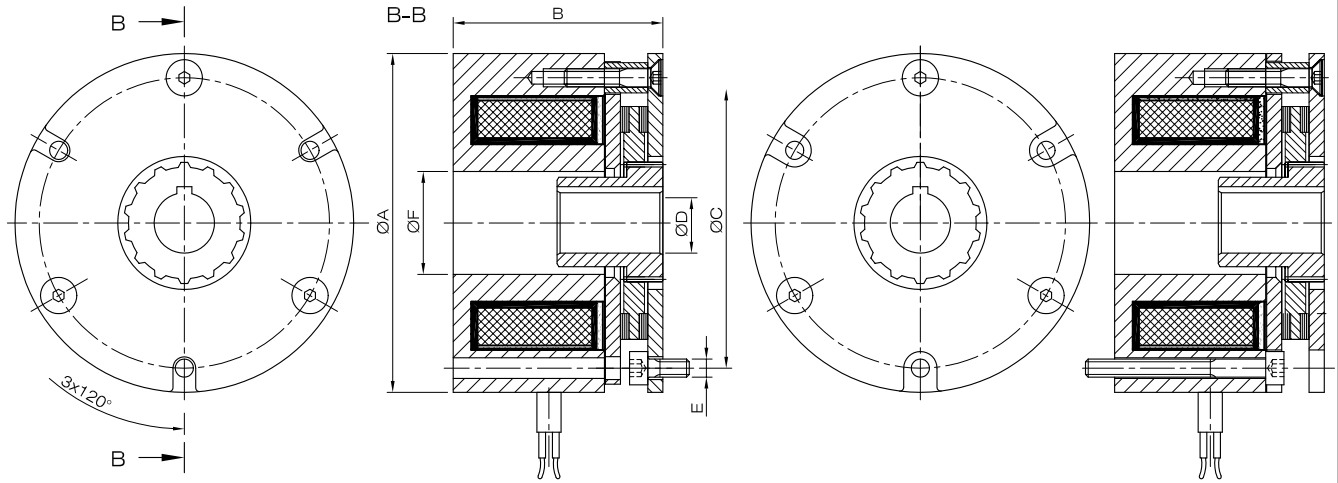

DIMENSIONS



PARAMETERS

Size	Mk	P _{20°}	D ^{H7}	ØA	B	ØC	ØE	ØF	H3	S ₁₀ ²	S ₁₀ max.
03	0.5	9	6/7/8	56	32	48	3xM3	17	15	0.15 ^{±0.1}	0.4
04	1	12.5	7/8/10	65	34	58	3xM3	20	15		
05	2	16	8/10/11	75	36	66	3xM4	24	15		

¹ Without keyway

² Minimum air gap, the actual value is determined by the sum tolerances of the individual components

Keyways to DIN 6885/ IS : 2048

Length of the connecting cable : 400 mm.

All Dimensions are in mm.

Subject to modifications.

Voltages: 24V, 205 V, (105V)

M_k: Rated torque for the brake in Nm., referred to
Δn = 100 rpm

Caution ! The braking torque depends on the speed

P₂₀ : Coil power at 20° C in W